

LINEAR LED RETROFIT KIT

PLEASE FIND A QUALIFIED ELECTRICIAN FOR INSTALLATION. Please read the instructions before you install and use the Linear LED Retrofit Kit FOLLOW ALL WARNING INSTRUCTIONS

DANGER - RISK OF SHOCK - DISCONNECT POWER BEFORE INSTALLATION

WARNING - Risk of fire or electric shock. LED Retrofit Kit installation requires knowledge of luminaires electrical systems. If not qualified, do not attempt installation.

WARNING - Product must be installed in accordance with the National Electrical Code or your local electrical code. If you are not familiar with these codes and requirements, contact a qualified electrician.

WARNING - Risk of fire or electric shock. Install this kit only in the luminaires that have the construction features and dimensions shown in the photographs and/or drawings and where the input rating of the retrofit kit does not exceed the input rating of the luminaire.

WARNING -To prevent wiring damage or abrasion, do not expose wiring to edges of sheet metal or any other sharp objects.

WARNING - Risk of fire or electric shock. Check the existing wiring and components for damage before installing upgrade kit.

WARNING - Do not make or alter any open holes in an enclosure of wiring or electrical components during kit installation.

Do not install if existing wires are damaged.

Suitable for damp locations and for use in totally enclosed luminaires.

GENERAL SAFETY INFORMATION

Review the diagrams thoroughly before beginning.

Before installation, disconnect the power by turning off the circuit breaker or by removing the appropriate fuse at the fuse box. Turning the power off using the light switch is not sufficient to prevent electrical shock.

Retrofit kit should be mounted in locations and at heights where it will not readily be subject to tampering by unauthorized personnel.

! WARNING DISCONNECT POWER BEFORE INSTALLING OR SERVICING.

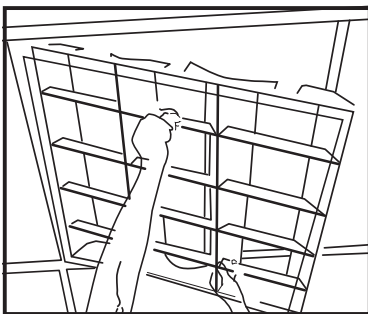

1. Open the old fixture's Cover



2. Remove the fluorescent Tubes & ballast

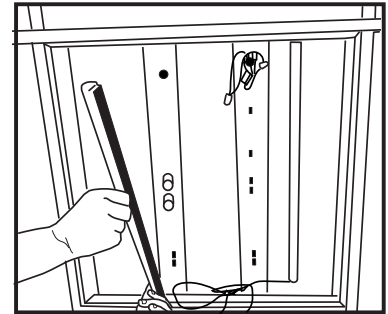

3. Install LED strip using the magnetic backing

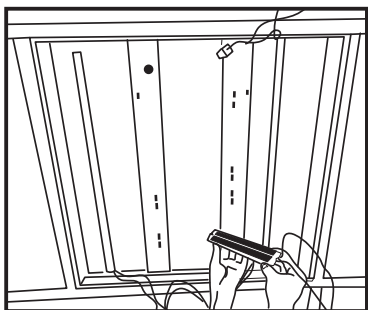

4. Install LED driver using the magnetic backing

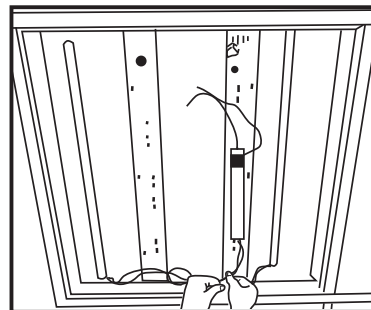

5. Connect the driver's input line

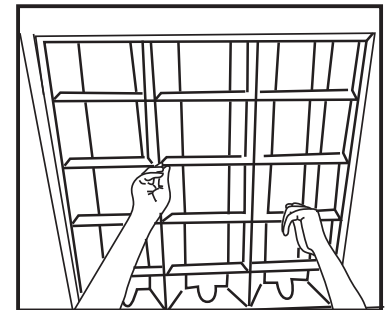

6. Close the Cover to finish installation